

- 1) Machine table
- 2) Spacer bar 6945-22-04
- 3) Clamping bar 6945-22-20-1x3
- 4) Front insertion guide 6945-22-02
- 5) Rear stop 6945-22-03

## No. 6945-22-04

### Spacer Bar



Order no.	Article no.	L x W x H	Weight [g]
61101	6945-22-04	425 x 50 x 44,5	7300

#### Design:

Tempering steel, phosphated. Tolerance of distance between holes  $\pm 0.2$ .

#### Application:

Spacer and guide bar for a clamping-rim or tool-pallet height of 30 mm.

#### Note:

For clamping bar: No. 6945-22-20-1x3.

#### On request:

Special sizes available on request.

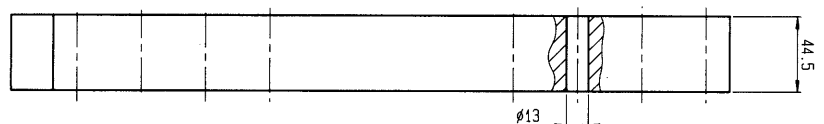
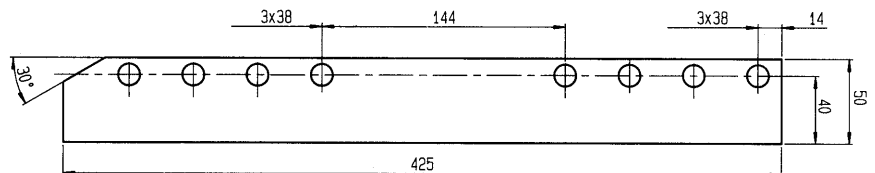

Subject to technical alterations.



CAD