

No. 6951FZ

Push-Pull Cylinder, base-flange-mounting, with guided piston rod

Double-acting,
max. operating pressure 350 bar,
min. operating pressure 35 bar.



CAD



Order no.	Article no.	Push force at 350 bar		Pull force at 350 bar		Stroke [mm]	Vol. push [cm ³]	Vol. pull [cm ³]	Q max. [l/min]	Weight [g]
		[kN]	[kN]	[kN]	[kN]					
66506	6951FZ-02-20	5,6	2,2	14,5	2,3	0,92	0,165	463		
66548	6951FZ-05-20	13,5	6,6	20,0	7,8	3,82	0,400	1150		
66589	6951FZ-11-20	27,7	13,9	29,5	23,0	11,90	1,640	2050		

Design:

Cylinder barrel from steel, hardened and burnished. Piston rod case hardened and chrome plated. Piston rod with internal thread and clamping arm positioning. O-ring for flange seal. Wiper at piston rod. Oil supply via threaded connection or oil channel in the fixture body.

Application:

Universal Push-Pull Cylinder for various applications.

Features:

Each cylinder size is available for single or double-acting operation. Various thrust pieces can be attached in the tapped piston rod ends. Clamps can be attached, as with the swing clamps.

Note:

The piston stroke is guided, respect Q max. volume flow. When mounting accessories at the piston, no force may be applied to the piston. When placing into operation, ensure that all air is bled from the system.

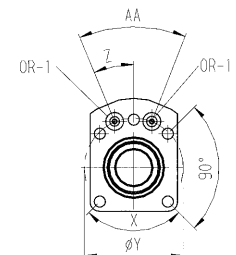

Hole circle f. O-ring connection

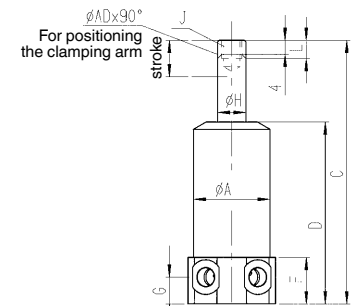

Drilling template device:

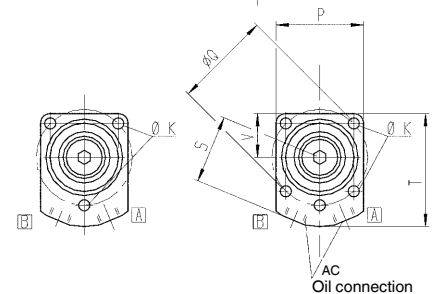
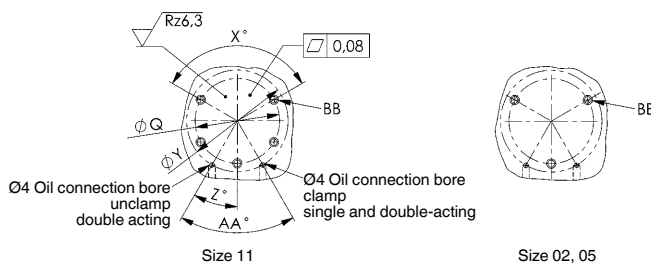

Size 02, 05

Size 11

A = Pull
B = Pressure

Dimensions:

Order no.	Article no.	dia. A	C	D	F	G	dia. H	J	dia. K	L	P	dia. Q	S	T	V	X°	dia. Y	Z°	AA°	AC	ØAD	BB	OR-1 O-ring Order No.
66506	6951FZ-02-20	26,8	103	71,0	26,5	13,5	11,13	M6	6	7	45	40,0	31,0	47	15,5	120	42	30,0	60	G1/8	3,2	M5	183608
66548	6951FZ-05-20	38,0	135	92,5	25,0	15,0	15,88	M10	7	12	57	50,0	33,5	54	19,0	120	50	55,0	110	G1/8	4,8	M6	183608
66589	6951FZ-11-20	45,4	173	112,5	28,5	16,5	22,23	M12	9	13	55	59,5	42,0	71	27,5	90	62	22,5	45	G1/4	4,8	M8	183608

Subject to technical alterations.