

## No. 6370ZSK

### Quick coupling „flat-face“ G1/8

Max. operating pressure 420 bar.

Order no.	Nominal bore [NW]	Nominal flow [l/min]	SW [mm]	Weight [g]
558043	4	3	17	38
558044	4	3	19	72

#### Application:

Since the clamping modules after blow-off of the opening pressure are mechanically locked, the hose is then uncoupled by means of the quick couplings. The advantage of this is that there are no interfering lines.

#### Note:

Flat-sealing quick coupling with internal thread G1/8.

Adapters from internal to external thread are not supplied as standard and must be ordered separately.

G1/8 to G1/8: order no. 558045

G1/8 to G1/4: order no. 558050

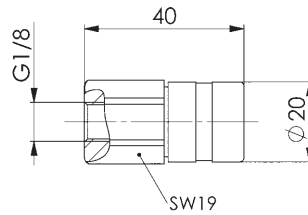

558044 Sleeve

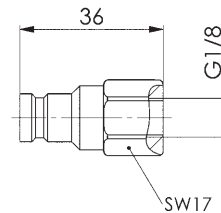

558043 Connector

## No. 6370ZSK

### Quick coupling „flat-face“ G1/4

Zinc-plated.

Max. operating pressure 300 bar.

Order no.	Nominal bore [NW]	Nominal flow [l/min]	SW [mm]	Weight [g]
427856	6	12	22	100
427872	6	12	22	170

#### Application:

Since the clamping modules after blow-off of the opening pressure are mechanically locked, the hose is then uncoupled by means of the quick couplings. The advantage of this is that there are no interfering lines.

#### Note:

Flat-sealing quick coupling with G1/4 internal thread. For G1/4 external thread a threaded stud is enclosed.

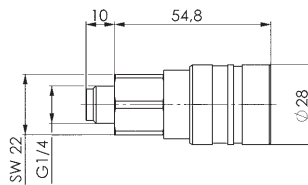

427872 Sleeve

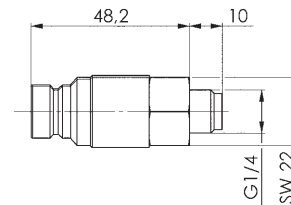

427856 Connector

CAD



Subject to technical alterations.